

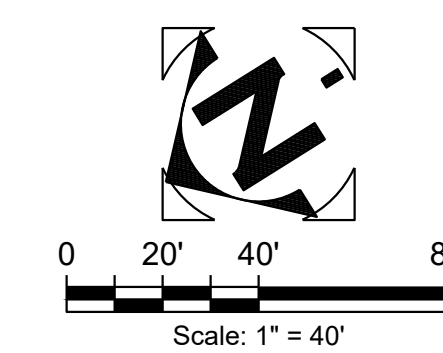

Revision Schedule		
MARK	ISSUE	DATE
6	ADDENDUM 06	03/12/2019



SIGNAGE AND STRIPING LEGEND

- 1 BICYCLE LANE MARKINGS
REF: COA DET. 8295-1A
- 2 2" TRAFFIC SIGNAL CONDUIT
REF: COA DET. 8355-1
- 3 TYPE A TRAFFIC BEARING PULL BOX
REF: COA DET. 8345-1
- 4 STANDARD ARROWS
REF: 2011 T MUTCD FIG. 3B-24
- 5 TYPICAL STANDARD PAVEMENT MARKINGS
REF: TXDOT DET. PM(1)-03
- 6 STANDARD PAVEMENT MARKINGS (WORDS)
REF: TXDOT DET. PM(5)-01
- 7 STANDARD PAVEMENT MARKINGS (ARROWS)
REF: TXDOT DET. PM(6)-01

NOTES:

1. SIGN LOCATIONS SHOWN WITHIN THE PUBLIC RIGHT OF WAY ARE APPROXIMATE. CONTRACTOR MUST COORDINATE FINAL SIGN LOCATIONS WITH THE INSPECTOR.
2. ALL SIGNS SHALL BE BREAK-AWAY CONSTRUCTION.
3. PAVEMENT MARKINGS SHALL BE TYPE 1 MARKING MATERIAL, PER TXDOT DMS-8220

KEY NOTES:

- A CROSSWALK, WHITE 18" PAINT STRIPES AT 36" ON CENTER
- B YELLOW 4" PAINT STRIPE
- C WHITE 24" PAINT STRIPE
- D YELLOW 8" PAINT STRIPE
- E WHITE 4" PAINT STRIPE
- F RED FIRE LANE STRIPING
- G LEFT-THRU ARROW
- H RIGHT ARROW
- I ONLY
- J ADA PARKING STRIPING
REF: SHEET C204B AND C204C
- K YELLOW 4" DASHED PAINT STRIPE
- L THRU ARROW
- M VAN ACCESSIBLE PARKING SIGN
- N ACCESSIBLE PARKING SIGN

Bus Loop

Parent Pick-Up

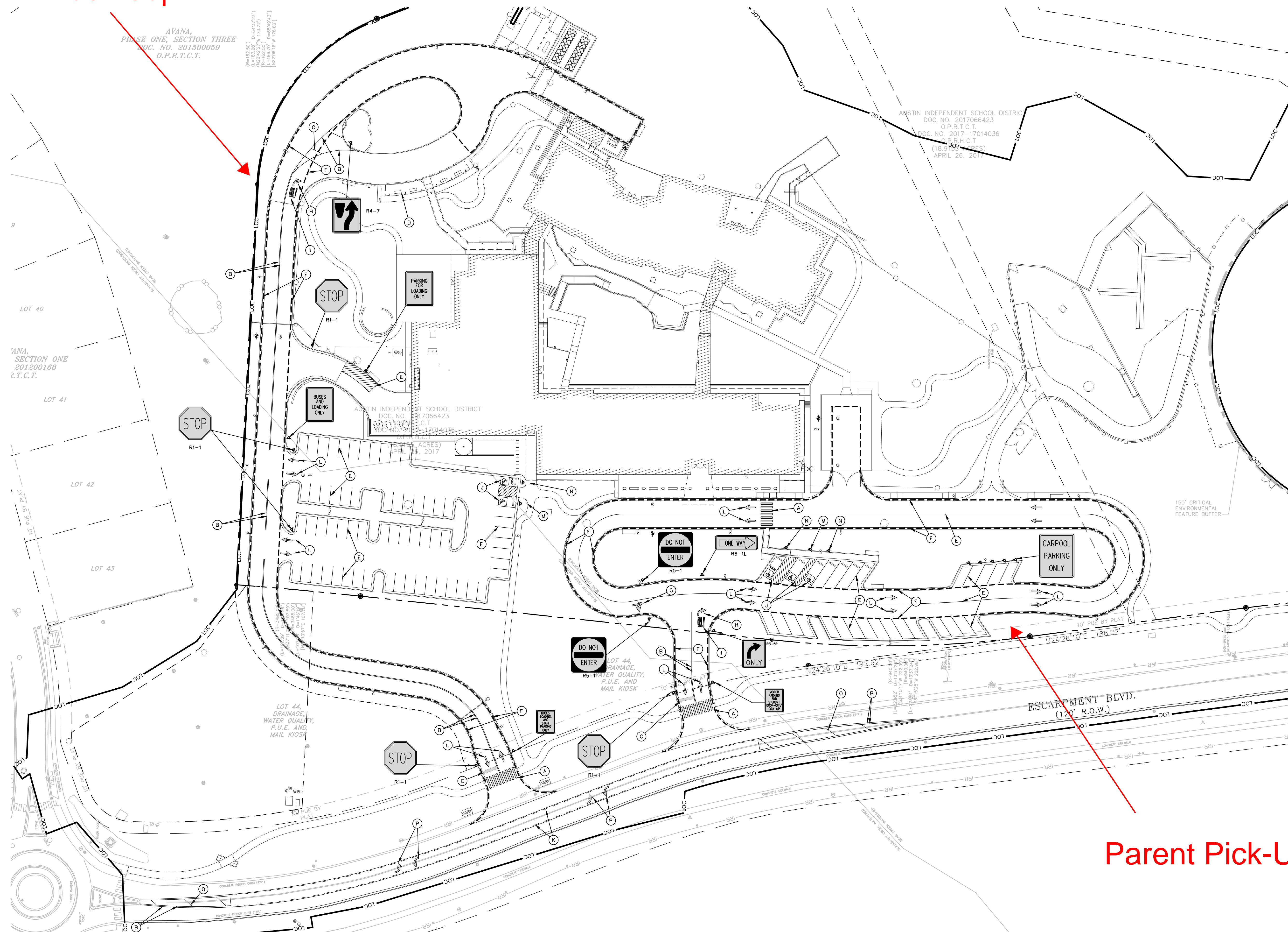

CONFORMANCE SET

**Austin
Independent
School District**

**New SW Elementary
School**

**SIGNAGE AND
STRIPING PLAN**

© 2018 Barnes Gromatzky Kosarek Architects
JOB NO: 1803
DATE: MARCH 28, 2019
RESERVED:
RESERVED: